



GENERAL INFORMATION

TECHNICAL EXHIBITION

FRPRCS-11

Venue and Date

Guimarães, Centro Cultural Vila Flor (<http://www.ccvf.pt/>), Portugal
26th to 28th June 2013

Technical exhibition

The technical exhibition is dedicated to the following topics:

- Materials and structural components;
- Equipment for the design, construction, monitoring and repair/strengthening of structures;
- Execution of structures: design and construction.

Participants

The technical exhibition is open to companies or institutions that are interested in the topics of the conference, namely owners of infrastructures, designers and consultants, producers and suppliers of materials and equipment, companies dedicated to construction and rehabilitation of structures.

Schedule

Setup: June 25th, 15h30-17h30

Opening: June 26th, 9h00

Closing: June 28th, 17h30

Disassembly: June 28th, 17h30-20h00

Exhibition area

The technical exhibition is located in both the Large and Small foyers of the auditoriums, where coffee breaks also take place.

A maximum of 15 stands are expected in the Foyer of the Large Auditorium, whereas in the Foyer of the Small Auditorium, a maximum of 5 stands is acceptable. The location and identification of each stand (6m² each) is shown in the plans below (stands numbered from 1 to 20). Furthermore, smaller exhibition areas of 2m² are available (8 in each Foyer), where exhibitors may place their marketing/informative materials. Such areas are identified by letters (*a* to *p*) in the following plans.

Foyer of the Large Auditorium

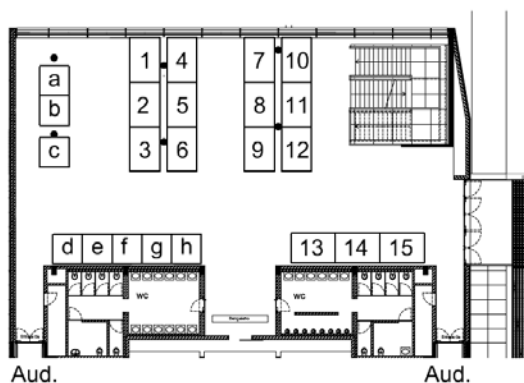

Foyer of the Small Auditorium

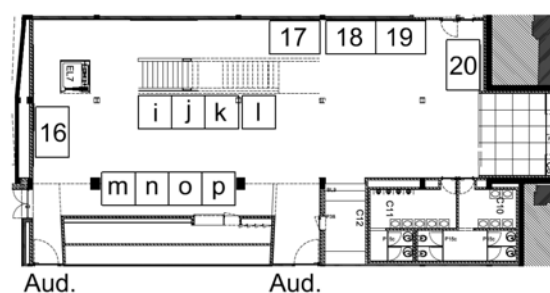



GENERAL INFORMATION

TECHNICAL EXHIBITION

FRPRCS-11

Registration

The registration form for the Technical Exhibition must be sent to the secretariat, together with the respective payment.

The Organizing Committee shall inform the exhibitors of the acceptance of their registration and indicate the assigned stand.

Stand choice is performed according to the order of registration arrival and confirmation of the respective payments. If it is not possible to satisfy the original stand choices, a new request is made among the remaining stands.

Stands have a total area of 6 m^2 ($3 \text{ m} \times 2 \text{ m}$), with dimensions and configuration as shown in the following figure. During the technical exhibition each stand includes: carpet, table, two chairs, electrical outlets. For the 2 m^2 ($2 \text{ m} \times 1 \text{ m}$) exhibition areas, a carpet and electrical outlets shall be made available.

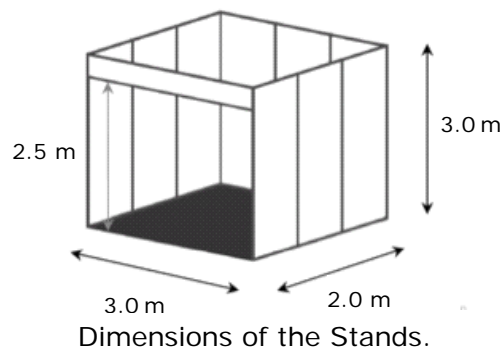

Dimensions of the Stands.

Cancellations

A written cancellation request must be sent to the Organizing Committee. The refunding of the registration fee is only possible if the cancellation request is performed before communication of registration acceptance.

Responsibilities

The Organizing Committee is responsible for order in the whole exhibition area, including the supply of electricity (standard 220-230V) and stand lettering.

The exhibitor is responsible for any necessary licences and insurances. The exhibitor will be held accountable for any damage caused to the congress/exhibition venue.



REGISTRATION FORM
TECHNICAL EXHIBITION
FRPRCS-11

Description of Applicant					
Company or Institute				VAT Number	
Address					
City		Zip Code		Country	
Contact person	Last name		First name		
Title					
Telephone			Fax		
E-mail address			Web site		
Name of person(s) with free registration					
5 numbers of stands (order of preference)					
5 numbers of 2m ² exhibition areas (order of preference)					

Type of participation and Fee		
	Fee	Choice (x)
Sponsor with exhibition – 2m ² area	2250	
Sponsor with exhibition – 6m ² stand	2900	
Sponsor with exhibition and highlighted reference	4900	
Total value		

Payment method		Amount
<input type="checkbox"/> Bank transfer	Bank: Millennium bcp	
	IBAN: PT50 0033 0000 00000231320 83 SWIFT: BCOMPTPL	
	Account holder's name: VIAGENS ABREU, SA	
<input type="checkbox"/> Credit card <input type="checkbox"/> Visa <input type="checkbox"/> Mastercard <input type="checkbox"/> Amex	Card No.:	
	Expiry date (month/date):	
	Cardholder's name:	
	Cardholder's signature:	

Please send this application form filled and the receipt of remittance (if paid by bank transfer) to FRPRCS-11 Exhibition Secretariat via Fax, email or air-mail to:

FRPRCS-11

Universidade do Minho, Departamento de Engenharia Civil

Azurém, P-4800-058 Guimarães

Tel.: +351 253 510747, Fax: +351 253 510217, E-mail: frprcs11@civil.uminho.pt

http:// www.frprcs11.uminho.pt

_____ Date

_____ Signature



Institute for Sustainability and Innovation in Structural Engineering



American Concrete Institute
Advancing concrete knowledge



FIB CANADA NETWORK ASSOCIATION