



**COST Action TU1207 Meeting**  
**fib TG9.3, 28<sup>th</sup> Meeting**  
**RILEM TC 234-DUC, 7<sup>th</sup> meeting**

**Guimarães**  
**Monday and Tuesday**  
**24-25<sup>th</sup> June 2013, 9h-18h**

### How to get to Guimarães?

- 1 – By Bus (at about 8€)
- 2 – By Train (at about 6€)
- 3 – By Taxi (at about 60-80€)

#### 1) By Bus ( <http://www.getbus.eu/> )

Porto airport → Guimarães (the bus departs from Porto airport - GET BUS firm)

Guimarães	05:00	07:30*	10:00	12:30	15:00	17:20	20:00
Airport	05:50	08:15	10:50	13:20	15:50	17:50	20:50

Guimarães → Porto airport (the bus departs from Guimarães bus station)

Guimarães	04:00	06:30	08:30	11:30	14:00	16:15	19:00*
Airport	04:50	07:15	09:15	12:20	14:50	17:05	19:50

Schedule valid from Monday to Sunday. \* Only works on Saturdays and Sundays.

#### Prices

	One-way	Return
Adult	8€	14€
5-12 Years	4€	8€



**COST Action TU1207 Meeting**  
**fib TG9.3, 28<sup>th</sup> Meeting**  
**RILEM TC 234-DUC, 7<sup>th</sup> meeting**

**2) By Train**



Take the **Underground** from **Airport** to **Campanhã Train Station**

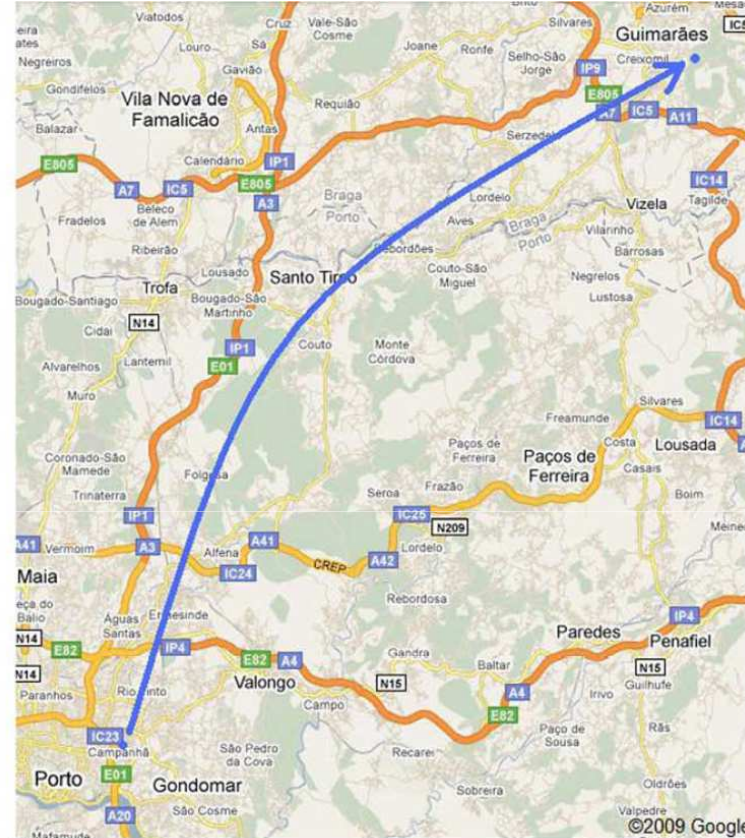

Take the train from **Campanhã** to **Guimarães**

Useful phone numbers:

Airport: (+351) 229 432 400

Oporto's Underground: (+351) 225 081 000

CP train network: (+351) 218 545 212

Taxi Guimarães: (+351) 253 513 535

University of Minho: (+351) 253 510 200

(+351) 253 510 218



**Meetings Venue:  
University of Minho  
Dep. of Civil Engineering (DEC)  
Meeting rooms**

**COST Action TU1207 Meetings  
24/06/2013 14h-19h, and 25/06/2013  
16h-19 in meeting Room 1 of DEC**

**fib TG9.3, 28<sup>th</sup> Meetings - 25/06/2013  
9h30-15h45: Plenary meeting and  
WG2 in meeting room 1 of DEC; WG3  
in meeting room B2.20A**

**RILEM TC 234-DUC Meeting -  
25/06/2013 9h30-15h45 in meeting  
room 3 of DEC**

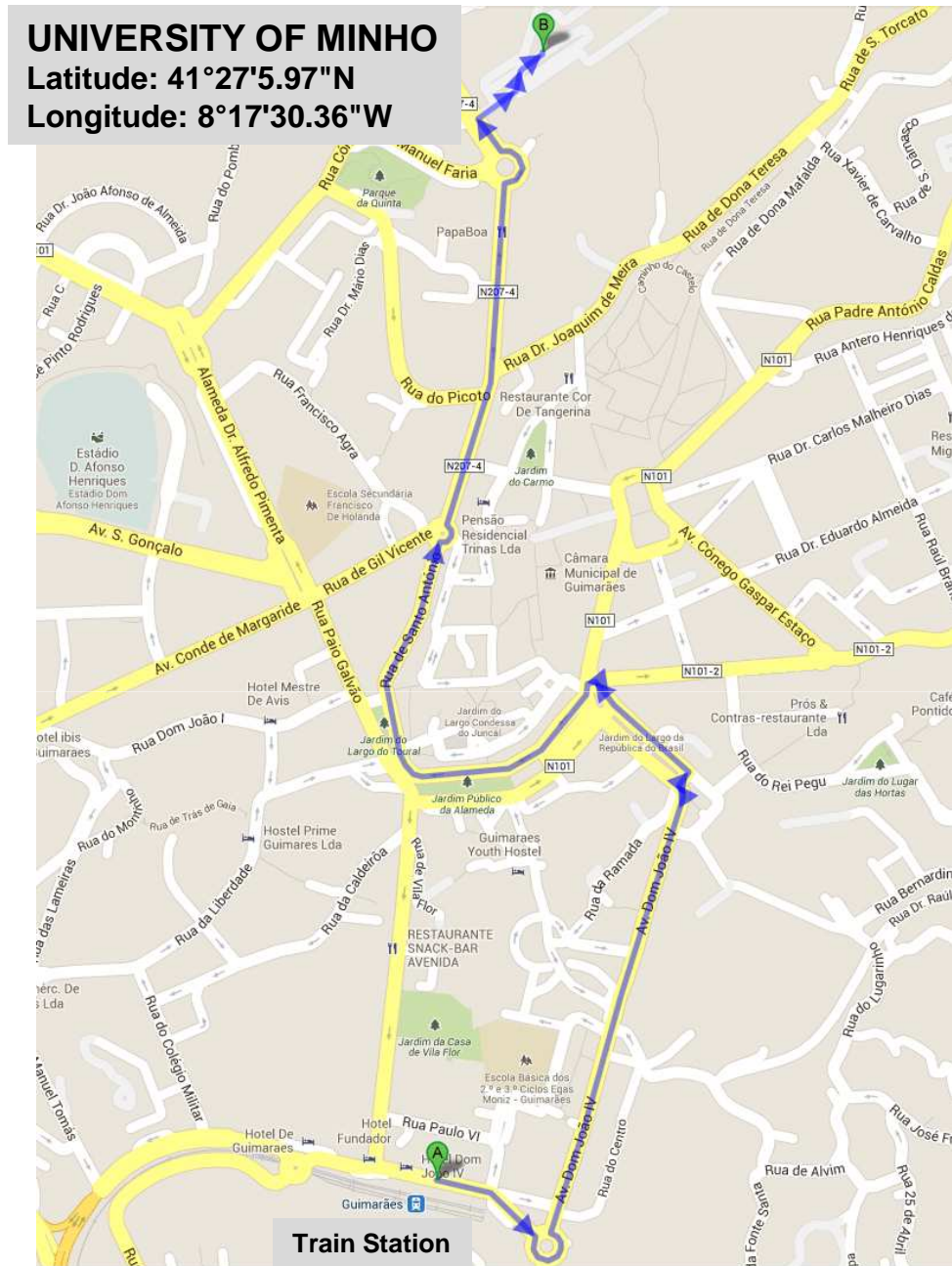

Take a **Taxi** or a **Bus** from Guimarães train station or Guimarães bus station to **University of Minho** or **Hotel**



COST Action TU1207 Meeting



fib TG9.3, 28<sup>th</sup> Meeting

RILEM TC 234-DUC, 7<sup>th</sup> Meeting

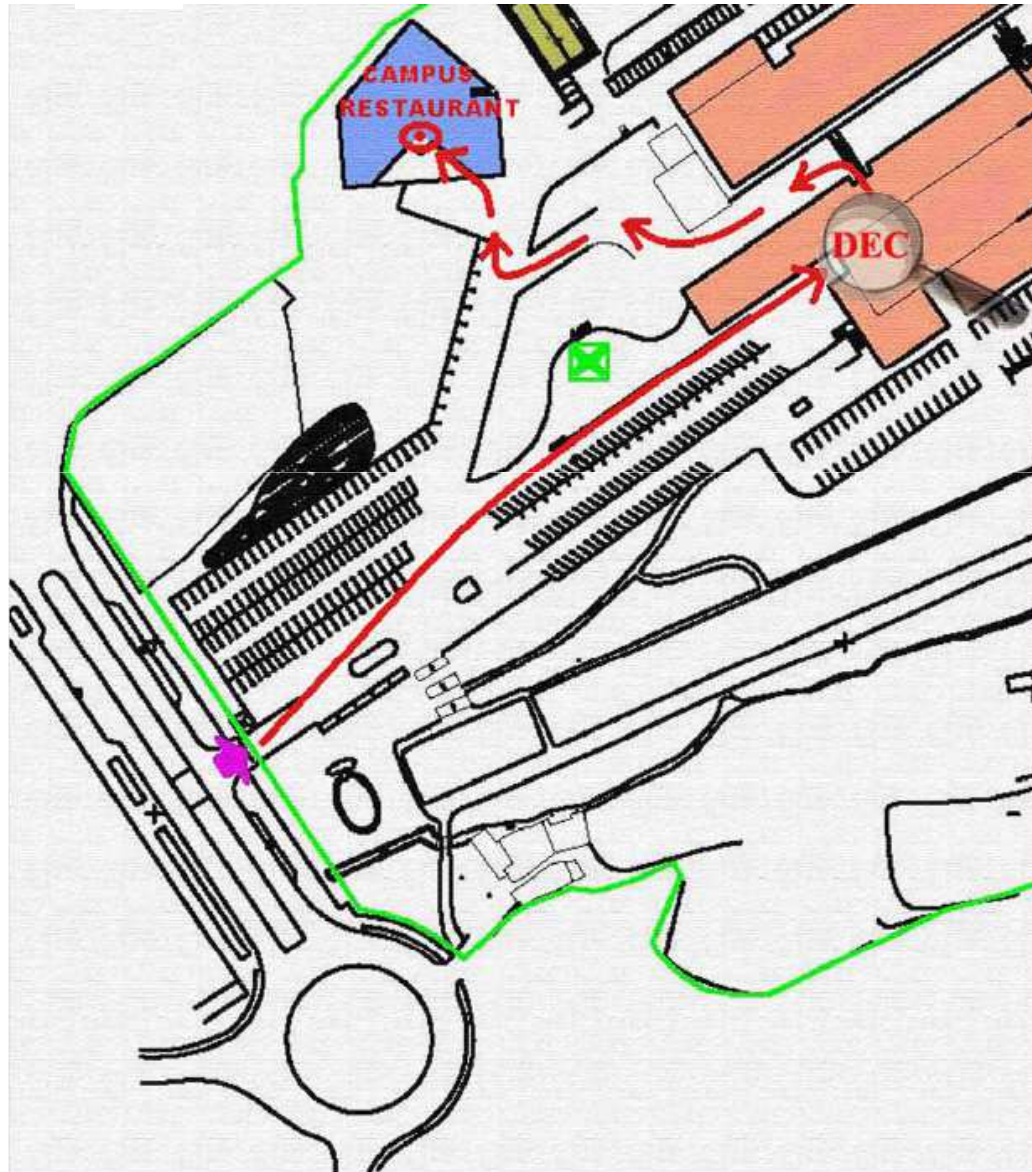

D.E.C. Map

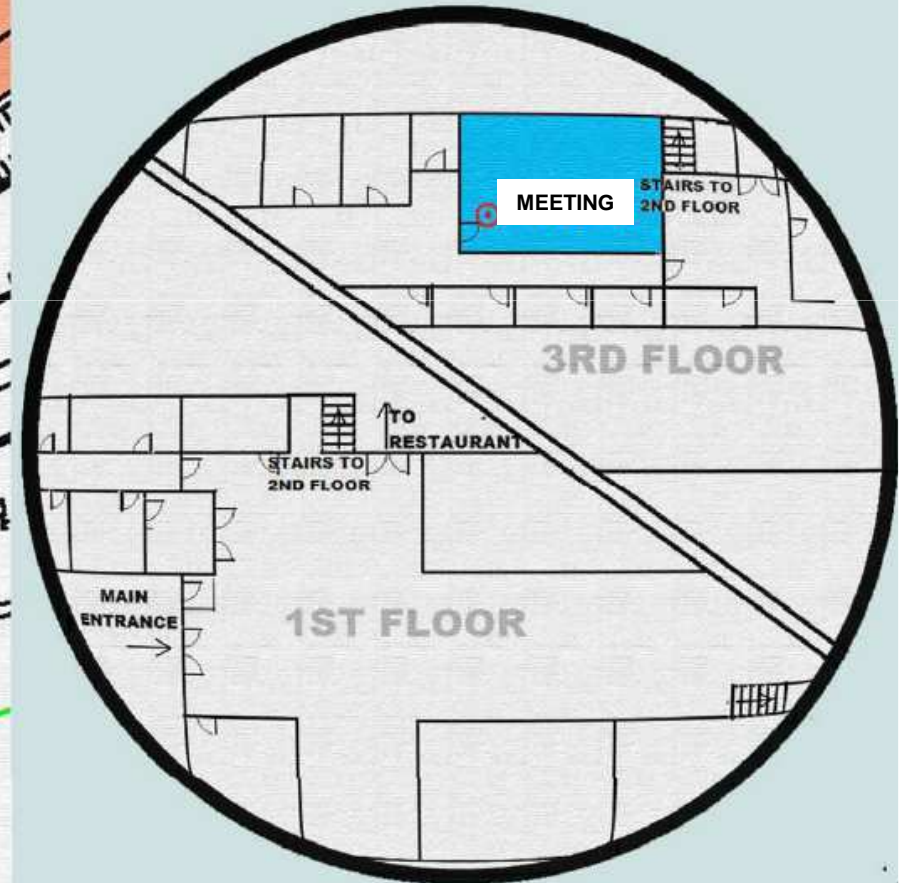



**COST Action TU1207 Meeting**



**fib TG9.3, 28<sup>th</sup> Meeting**

**RILEM TC 234-DUC, 7<sup>th</sup> meeting**

### Useful Contacts:

#### University of Minho

Campus de Azurém

4800-058 Guimarães

Tel: (+351) 253 510 200

(+351) 253 510 210

#### Hotels

Please check the hotels that offer special prices for the FRPRCS-11 conference participants.

Detailed information and booking is available on the conference website:

[www.frprcs11.civil.uminho.pt](http://www.frprcs11.civil.uminho.pt), on the **SYMPOSIUM REGISTRATION** that is available in

#### Accommodation.

During 2013, the city of Guimarães is the European City of Sports. Therefore, hotels will be in high demand. Make your reservation as soon as possible.